

**Petlibro**

Scout Smart Camera

PLPC001-V0002

FCC ID: 2A3DE-PLPC001

IC: 28987-PLPC001

CAN ICES-003 (B)/NMB-003(B)

**Model:** PLPC001 / PLPC001

**@Libro Corp. All Rights Reserved.**

**Manufacturer:** Shenzhen Libro Technology Co., Ltd.

**Address:** 12/F, Tower B, GALAXY WORLD,  
Yabao Road, Longgang District, Shenzhen, China

**Made in China**



This device complies with Part 15 of the FCC Rules. Operation is subject to the following two conditions: (1) this device may not cause harmful interference, and (2) this device must accept any interference received, including interference that may cause undesired operation.

[petlibro.com](http://petlibro.com)

# PETLIBRO

# USER MANUAL

Scout Smart Camera



Please read this manual before using your camera and keep it for future reference.

# CONTENTS

IN THE BOX	01
PRODUCT OVERVIEW	03
GETTING STARTED	05
INSTALLATION	08
RESET	11
INDICATOR LIGHT	12
SAFETY INSTRUCTIONS	14
SPECIFICATIONS	15
WARRANTY	15
NOTICE	16

# IN THE BOX

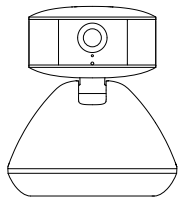

**X1**

Camera

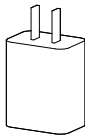

**X1**

Power Adapter

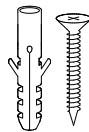

**X2**

Screws and Screw Anchors



**X1**

L-Shaped Wall Mount

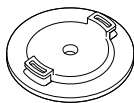

**X1**

Mounting Plate

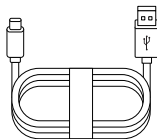

**X1**

Power Cord

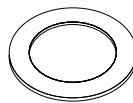

**X1**

Adhesive Mount

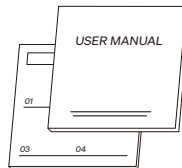

**X1**

Quick Start Guide and User Manual

**NOTE:** The contents listed above apply to the one-pack version. For multi-pack versions, the contents (excluding the Quick Start Guide and User Manual) will increase proportionally.

# PRODUCT OVERVIEW

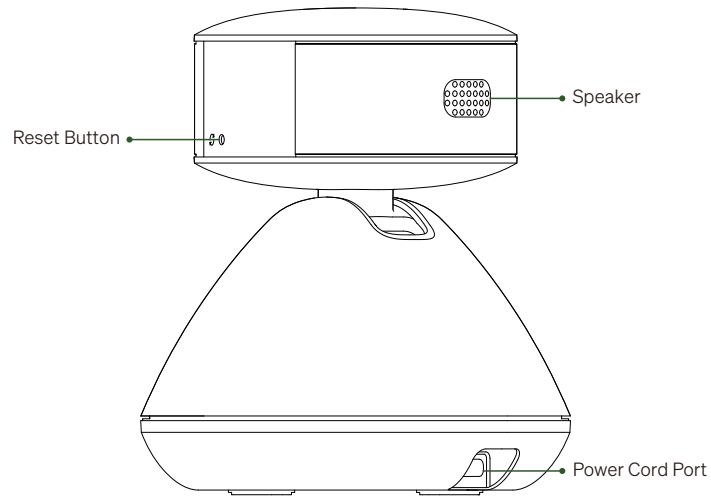
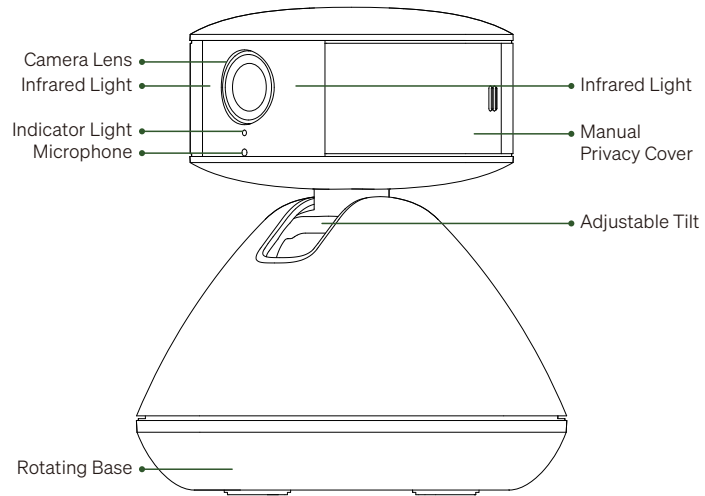



# GETTING STARTED

## 01 / Power Connection

Connect your camera to a power supply and your camera will automatically start. When the white indicator light under the lens starts flashing, your camera is ready for app connection.

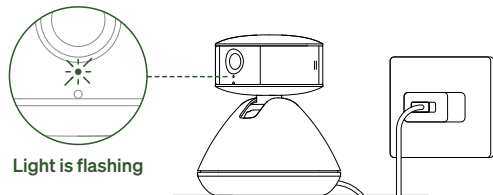

## 02 / Download the Petlibro App

Scan the QR code with your mobile phone or search for "Petlibro" in your smartphone's app store to download and install the app.



**NOTE:** The app named "Petlibro Lite" is not the correct app for your camera. If you have already downloaded and installed the Petlibro app on your phone, please ensure it is updated to the latest version.

## 03 / Wi-Fi Connection

- **Option A:** Turn on your phone's Bluetooth to find the camera you want to add.

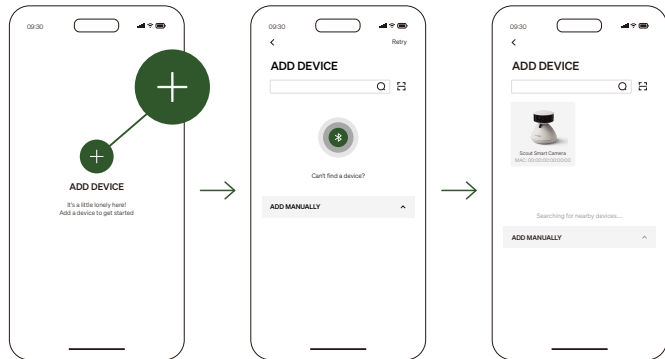

- **Option B:** Using your camera to scan the QR code in app.

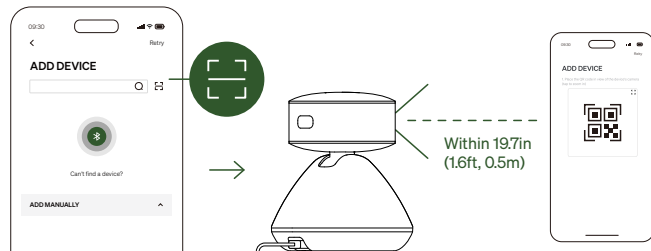

### Need more support?

Scan the QR code below for the digital version of user manual and more operating tutorials, or reach out to our customer support at [support@petlibro.com](mailto:support@petlibro.com)



Written Guides



Video Tutorials

# INSTALLATION

This camera supports both freestanding and mounted installations.

## ! Installation tips

- Set the camera up indoors
- Position your camera with a strong Wi-Fi connection
- Keep your camera at least 10in / 25cm away from metal objects (e.g., microwaves)
- Do not face the camera lens directly towards mirrors or bright lights

## 01 / Freestanding

Your camera can be flexibly placed on flat surfaces, such as cabinets, dining tables, coffee tables, and more. Position it wherever you like, as long as there's an available power socket nearby.

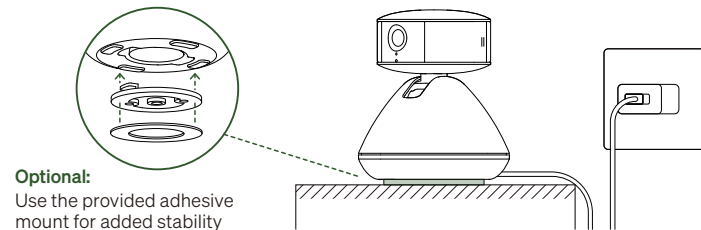

## 02 / Wall Mount

Your camera can be installed on the wall. Follow the steps below for installation.

### Step 01

- Mark two holes on your chosen wall spot.
- Drill holes using a 1/4 inch drill bit.

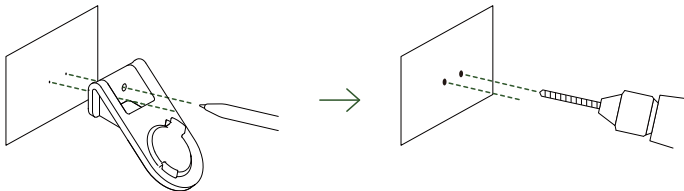

### Step 02

- Insert the provided screw anchors (0.23 × 1in / 6 × 25mm) into holes.
- Position L-shape wall mount facing up and secure with screws.

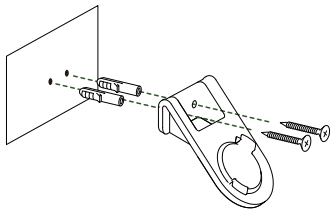

### Step 03

- Thread the power cord through the mount, connect it to the camera, then attach the camera to the mount.

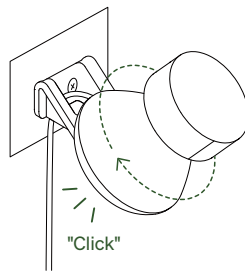
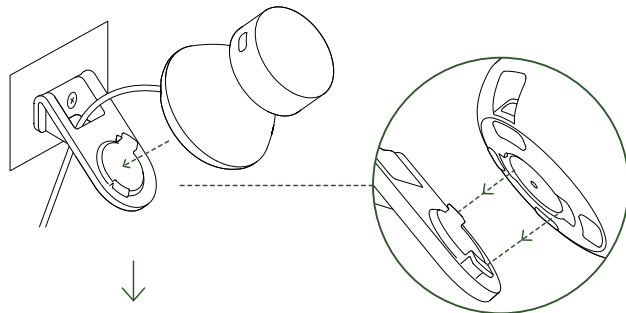

### ! Tips:

- For wood or drywall, skip the drilling and screw anchors, and screw the wall mount directly into the wall
- Use provided accessories only

## 03 / Tripod Mount

Your camera can be installed on a tripod. Follow the steps below for installation.

- Attach the mounting plate to the tripod using the 1/4" tripod screw.
- Set your camera on mounting plate and twist to lock.

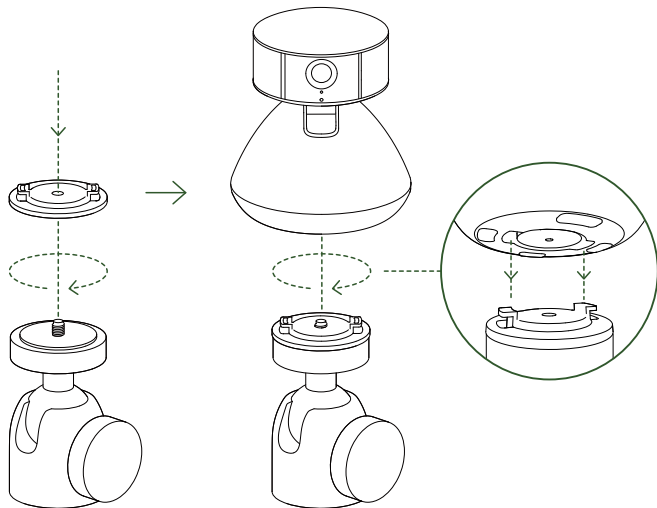

# RESET

If you want to connect your camera to a new smartphone, you need to unbind it from your old smartphone first, then reset your camera. Please follow these steps:

- Close the privacy cover manually.
- Press the reset button for 5 seconds using a pin (not included) until you hear the "Reset Successful" prompt tone.
- Open the privacy cover.
- Wait for 5 seconds; a white light flashing slowly indicates a successful reset.
- Connect the camera to your new smartphone.

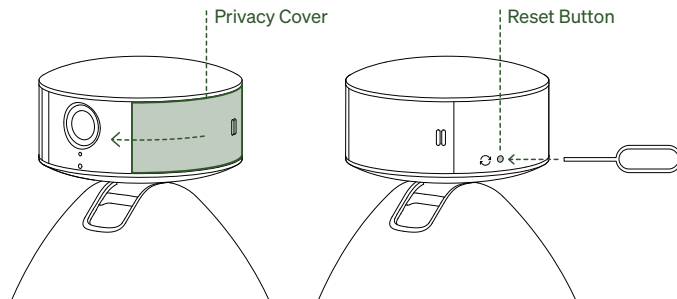

# INDICATOR LIGHT

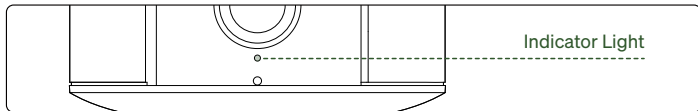

## During Network Configuration

No light	Powered off or powering on.
White light flashes once per second	Waiting for network configuration. This occurs during the first setup, after a reset, or network configuration fails.
White light flashes every half second	Connecting to Bluetooth or Wi-Fi.
White light stays on	Wi-Fi is connected. Working mode is turned on.

## During Operation

No light	Powered off.
White light stays on	Normal operation.
Blue light stays on	In-app remote monitoring, recording, or two-way voice system is activated.
White light flashes every half second	Software is updating.
Red light flashes once per second	Wi-Fi disconnected.

# SAFETY INSTRUCTIONS

- The operating temperature range for your camera is between -4°F and 113°F (-20°C–45°C). Do not use your camera in environments with temperatures outside this specified range.
- Your camera is a precision electronic product. To ensure its normal operation, do not use your camera in environments with high humidity levels, and do not submerge in water or get the camera wet.
- Only use accessories recommended or sold by the manufacturer. Using accessories not approved by the manufacturer may result in unsafe conditions.
- The provided stickers are designed for freestanding placement on horizontal surfaces only. Do not use them on vertical surfaces as the camera may fall.
- When the camera is installed in a high place, please check that it is placed properly and not easily tipped over, so that it will not fall and cause equipment damage or accidents.

# SPECIFICATIONS

Model	PLPC001 / PLPC0001
Resolution	1920 × 1080P
Power Adapter	Input: AC 100–240V 50/60Hz Output: DC 5V 2A
Operating Temperature	-4°F–113°F / -20°C–45°C
Wireless Frequency	2.4GHz, 5GHz
Supported Systems	Android, iOS
Dimensions	3.6 × 3.6 × 4.1in / 92 × 92 × 104mm
Net Weight	0.61lb / 276g

# WARRANTY

- 24-month warranty
- For more guidance on support, you can contact our customer service team via email: [support@petlibro.com](mailto:support@petlibro.com)

# NOTICE

## FCC Statement

**This device complies with Part 15 of the FCC Rules. Operation is subject to the following two conditions:**

- this device may not cause harmful interference, and
- this device must accept any interference received, including interference that may cause undesired operation.

**NOTE:** This equipment has been tested and found to comply with the limits for a Class B digital device, pursuant to Part 15 of the FCC Rules. These limits are designed to provide reasonable protection against harmful interference in a residential installation. This equipment generates, uses and can radiate radio frequency energy and, if not installed and used in accordance with the instructions, may cause harmful interference to radio communications. However, there is no guarantee that interference will not occur in a particular installation.

If this equipment does cause harmful interference to radio or television reception, which can be determined by turning the equipment off and on, the user is encouraged to try to correct the interference by one or more of the following measures:

- Reorient or relocate the receiving antenna.
- Increase the separation between the equipment and receiver.
- Connect the equipment into an outlet on a circuit different from that to which the receiver is connected.
- Consult the dealer or an experienced radio/TV technician for help.

**This device contains licence-exempt transmitter(s)/receiver(s) that comply with Innovation, Science and Economic Development Canada's licence-exempt RSS(s). Operation is subject to the following two conditions:**

- This device may not cause interference.
- This device must accept any interference, including interference that may cause undesired operation of the device.

Changes or modifications to this unit not expressly approved by the party responsible for compliance could void the user's authority to operate the equipment.

This equipment complies with FCC's and IC's RF radiation exposure limits set forth for an uncontrolled environment. The antenna(s) used for this transmitter must be installed and operated to provide a separation distance of at least 7.8in / 20cm from all persons and must not be collocated or operating in conjunction with any other antenna or transmitter. Installers must ensure that 7.8in / 20cm separation distance will be maintained between the device (excluding its handset) and users.

## **WEEE Disposal and Recycling Information**

All products bearing this symbol are waste electrical and electronic equipment (WEEE as in directive 2012/19/EU) which should not be mixed with unsorted household waste. Instead, you should protect human health and the environment by handing over your waste equipment to a designated collection point for the recycling of waste electrical and electronic equipment, appointed by the government or local authorities. Correct disposal and recycling will help prevent potential negative consequences to the environment and human health. Please contact the installer or local authorities for more information about the location as well as terms and conditions of such collection points.

## **Legal Disclaimer Notice**

This legal disclaimer applies to purchasers and users of products manufactured by or on behalf of Shenzhen Libro Technology Co., Ltd. and its affiliates (collectively, "Petlibro").

Unless otherwise expressly indicated in writing, Petlibro's products and instructions relating thereto are subject to change without notice. Users should check for and obtain the latest relevant information and verify that such information is current and complete before placing orders for Petlibro products.

Unless Petlibro has explicitly designated an individual Petlibro product as meeting the requirements of a particular industry standard or a particular qualification, Petlibro is not responsible for any failure of an individual Petlibro product to meet the requirements of such industry standard or particular qualification.

The purchasers and users of Petlibro product are recommended to check the product label or USER MANUAL prior to using any of our products. If there are any discrepancies customers should follow the information provided in the product or packaging. You should contact the manufacturer directly for any clarification relating to the product and recommended use. Unless expressly and specifically approved in writing by Petlibro on a case-by-case basis, use of any Petlibro products in unauthorized applications might not be safe and thus is at the user's sole risk.

To the maximum extent permitted by applicable law, Petlibro disclaims (i) any and all liability for special, punitive, consequential, incidental or indirect damages or lost revenues or lost profits, and (ii) any and all implied warranties, including implied warranties of fitness for particular purpose, non-infringement and merchantability.